

General info

Technical - Recessed lights



Ean	8021696274775
Item	ONE 2W D2.5
Installation	Recessed lights
Warranty	5 years
Gross weight	0.09 kg
Volume	6e-05 m ³

Technical info

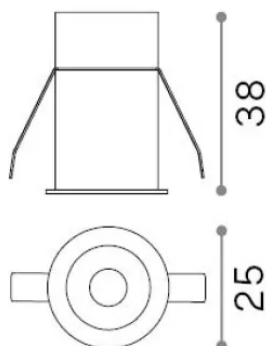

Net weight	0.07 kg
Insulation class	II
Protection index	IP20
Compliance	CE
Operating temperature	0° ~ +40 °C [DO NOT COVER]
Dimmer	Non-dimmable, On-Off
Power output	220-240 V AC 50/60 Hz
Power supply	Separate, included Replaceable (by qualified operators only), electronic

Source info

Integrated source	Integrated LED module
Replaceable source	Replaceable (by qualified operators only)
Power	2 W
Emission	Direct
Max consupcion	max 2 W
Features LED	LED SMD
CCT LED	3000 K
Duration LED (t. 25°C)	30000 h
CRI	> 90
SDCM	3
Light beam	30°
Light beam flux	130 lm
Useful light flux	70 lm
Photobiological risk	2