

General info

Technical - Recessed lights



Ean	8021696274782
Item	ONE 3W D3.6
Installation	Recessed lights
Warranty	5 years
Gross weight	0.21 kg
Volume	0.000315 m³

Technical info

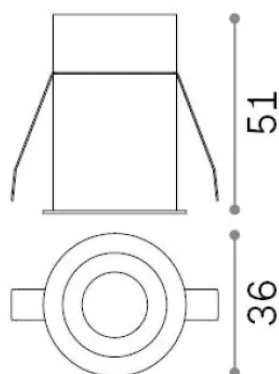

Net weight	0.1 kg
Insulation class	II
Protection index	IP20
Compliance	CE
Operating temperature	0° ~ +40 °C [DO NOT COVER]
Dimmer	Non-dimmable, On-Off
Power output	220-240 V AC 50/60 Hz
Power supply	Separate, included Replaceable (by qualified operators only), electronic

Source info

Integrated source	Integrated LED module
Replaceable source	Replaceable (by qualified operators only)
Power	3 W
Emission	Direct
Max consupcion	max 3 W
Features LED	LED SMD
CCT LED	3000 K
Duration LED (t. 25°C)	30000 h
CRI	> 90
SDCM	3
Light beam	23°
Light beam flux	270 lm
Useful light flux	180 lm
Photobiological risk	2